

# Micro Installation Beacons - 23x

## Your benefits

Despite their size, micro installation beacons from the 230 / 231 / 232 range will provide good all-round visibility. The range includes control panel indicator lights.

- The industry standard for control panels
- Easy to install, even where space is restricted

## Typical applications

Signalling faults and statuses

- On small machines and equipment
- In building technology

## Installation options

- M22 single-hole mounting including nut
- M20 for direct installation, in safety switches, for example

## Features

- Available with a permanent light
- Powerful xenon flash light for increased visibility



Size comparison  
Micro/Mini/EvoSIGNAL Mini

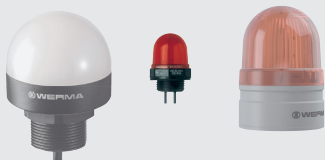

# 230 LED Installation Beacon



Mainly sideways illumination



The LED Installation Beacon 230 can for example be used in applications with cable-operated switches or limit switch devices

## ① TECHNICAL SPECIFICATIONS/ORDER SPECIFICATIONS:

Dimensions (Ø x Height):	29 mm x 32 mm (Protrusion from panel)			
Housing:	PC/ABS-Blend			
Lens:	PC, transparent			
Connection:	2 wires, c. 115 mm long			
Fixing:	Installation mounting for Ø 20.5 mm (M20 x 1.5 mm)			
Life duration:	Up to 100,000 hrs			
Seal included in assembly.				
Voltage:	12 V DC	24 V DC	115 V AC	230 V AC
Current consumption:	80 mA	45 mA	15 mA	20 mA
red	<b>230 100 54</b>	<b>230 100 55</b>	<b>230 100 67</b>	<b>230 100 68</b>
yellow	<b>230 300 54</b>	<b>230 300 55</b>	<b>230 300 67</b>	<b>230 300 68</b>
clear	-	<b>230 400 55</b>	-	-
Further colours on request.				

## ← TECHNICAL DIAGRAM:

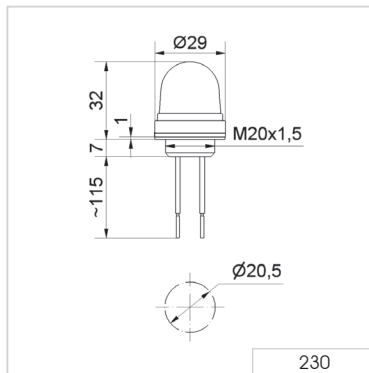

24 V





Mainly sideways illumination

## 231 LED Installation Beacon

### ① TECHNICAL SPECIFICATIONS/ORDER SPECIFICATIONS:

Dimensions (Ø x Height):	29 mm x 32 mm (Protrusion from panel)			
Housing:	PC/ABS-Blend			
Lens:	PC, transparent			
Connection:	2 wires, c. 105 mm long			
Fixing:	Installation mounting for Ø 22.5 mm (M22 x 1.5 mm)			
Life duration:	Up to 100,000 hrs			
Nut and seal included in assembly.				
Voltage:	12 V DC	24 V DC	115 V AC	230 V AC
Current consumption:	80 mA	45 mA	15 mA	20 mA
red	<b>231 100 54</b>	<b>231 100 55</b>	<b>231 100 67</b>	<b>231 100 68</b>
green	<b>231 200 54</b>	<b>231 200 55</b>	<b>231 200 67</b>	<b>231 200 68</b>
yellow	<b>231 300 54</b>	<b>231 300 55</b>	<b>231 300 67</b>	<b>231 300 68</b>
clear	<b>231 400 54</b>	<b>231 400 55</b>	<b>231 400 67</b>	<b>231 400 68</b>
blue	<b>231 500 54</b>	<b>231 500 55</b>	<b>231 500 67</b>	<b>231 500 68</b>

### ↔ TECHNICAL DIAGRAM:

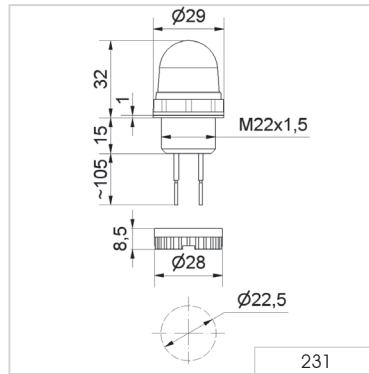

24 V



## 232 Installation Xenon Flashing Beacon



### ① TECHNICAL SPECIFICATIONS/ORDER SPECIFICATIONS:

Dimensions (Ø x Height):	29 mm x 32 mm (Protrusion from panel)	
Housing:	PC/ABS-Blend	
Lens:	PC, transparent	
Connection:	2 wires, c. 600 mm long	
Fixing:	Installation mounting for Ø 22.5 mm (M22 x 1.5 mm) with anti-twist device	
Flash frequency:	1.5 Hz	
Flash energy:	1 Ws	
Life duration:	4 x 10 <sup>6</sup> flashes	
Nut and seal included in assembly.		
Voltage:	24 V DC	230 V AC
Current consumption:	140 mA	20 mA
red	<b>232 100 55</b>	<b>232 100 68</b>
yellow	<b>232 300 55</b>	<b>232 300 68</b>

### ↳ TECHNICAL DIAGRAM:

